

3 12mm (1/2") gas-tec glue gun

The **gas-tec600** is a robust compact hotmelt glue gun that runs on butane gas. It does not require mains electricity or batteries but operates using easily refillable LEC™ (Liquid Energy Cells) power technology. The **gas-tec 600** has been built to a very high standard and incorporates a soft-feel handle and full-hand trigger, making it a very comfortable gun to use.

- > Refill the LEC™ gas cartridge using standard cigarette lighter canisters.
- > Refills in just 15 seconds - sufficient to keep the **gas-tec 600** running for approximately 1½ hours.
- > Easy to start up - simply turn the gas dial and press the piezo ignition button.
- > Reaches operating temperature in just 5 minutes.
- > Thermostatically controlled to give the optimum temperature to achieve the best glue delivery.
- > The **gas-tec 600** can be used for a huge range of applications from shop fitting, exhibition displays, flooring and carpet laying, ceramic tile displays, low voltage wiring, to dent repairs on cars and many more.

Melt rate	1.5kg (3.3lbs)/hr
Glue size	12mm (1/2") glue stick
Voltage	Gas powered
Wattage	185W
Heater	Catalytic
Temp Control	Thermostatic gas valve
Hot melt gun °C (°F)	195°C (380°F)
Low melt gun °C (°F)	Not available
Power cable	Cordless
Weight	390g (14oz)
Packaging	PET blister (10 per ctn)

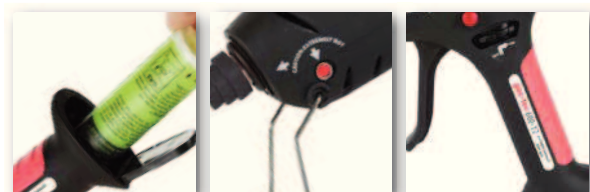

Refillable cartridges
LEC™ (Liquid
Energy Cells)

ON indicator
window & silicon
rubber nozzle shroud

Full-hand
soft-feel trigger
& handle



Gas ON/OFF wheel
& ignition button

Refilling
LEC™ cartridges

Takes standard
12mm (1/2") glue
sticks

